

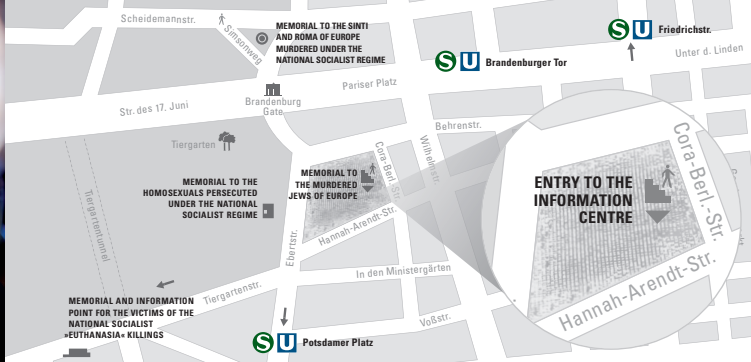

Visitor with an audio guide at the Information Centre



Location map and entry to the exhibition



OUR RECOMMENDATIONS FOR YOUR VISIT

Audio tour through the exhibition

Languages: German, English and Dutch

Price: 3 euros

Audio translation of exhibition text

Languages: Spanish, Italian, French, Hebrew, Polish, Portuguese and Russian

Price: 3 euros

Tours for visitors with special requirements

For visitors with hearing impairments we offer video tours in German sign language with subtitles. For the blind and visitors with visual impairments we offer adapted guides.

Languages: German, simplified language, international sign with English subtitles

Price: free of charge

Free public tours

Sat 3 pm (English), Sun 3 pm (German)

Meeting spot: The lift at the corner of Cora-Berliner-Str. and Hannah-Arendt-Str.

Group tours, workshops and project days

Please visit www.stiftung-denkmal.de for more information!

Contact for enquiries and bookings

Phone +49-(0)30-26 39 43-36

besucherservice@stiftung-denkmal.de

OPENING TIMES, ADDRESS AND CONTACT

Field of Stelae (free admission)

Open 24 hours a day

Information Centre (free admission)

Apr.-Sep.: Tues.-Sun 10 am - 8 pm (last admission 7.15 pm)

Oct.-Mar.: Tues.-Sun 10 am - 7 pm (last admission 6.15 pm)

Address

Cora-Berliner-Str. 1, 10117 Berlin, www.stiftung-denkmal.de

Public Transport

Brandenburger Tor and Potsdamer Platz stations

Foundation

Phone +49-(0)30-26 39 43-11, info@stiftung-denkmal.de

Visitor services

Mon - Thurs 10-4 pm, Fri 10-1 pm

Phone +49-(0)30-26 39 43-36, Fax -21

besucherservice@stiftung-denkmal.de

Press

Phone +49-(0)30-26 39 43-26, presse@stiftung-denkmal.de

Donations

To support our work: Berliner Sparkasse,

Account: 6600 0076 62, BLZ: 100 500 00, BIC: BELADEBEXXX

IBAN: DE24 1005 0000 6600 0076 62 · Thank you!

Funded by



Federal Government Commissioner
for Culture and the Media

upon a decision
of the German Bundestag



MEMORIAL TO THE MURDERED JEWS OF EUROPE FIELD OF STELAE AND INFORMATION CENTRE



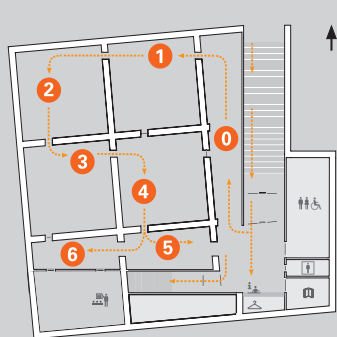

Construction site (2004) · Room plan Information Centre



1 · Room of Dimensions



3 · Room of Names

CHRONOLOGY AND REFERENCES

The Memorial to The Murdered Jews of Europe in the centre of Berlin is Germany's main Holocaust memorial. It dates back to a citizen's initiative by the publicist Lea Rosh and the historian Eberhard Jäckel in the late 1980s. On June 25th, 1999, the German Bundestag passed a resolution to start construction according to architect Peter Eisenman's design.

Construction started on April 1st, 2003, and the memorial was presented to the public on May 12th, 2005.

The memorial consists of a 19,000 m² field of stelae with over 2,700 concrete blocks, and the information centre lies below. Almost half a million visitors view the exhibition each year. The memorial is maintained by the Foundation of the Memorial to the Murdered Jews of Europe.

Field of Stelae

- Access is year-round at visitors' own risk.
- Climbing on the stelae pillars is prohibited.
- Loud noises, smoking and the consumption of alcohol are prohibited.

Information Centre (under the Field of Stelae)

- Waiting times may vary according to security checks and the number of visitors.
- The exhibition is not recommended for children under the age of 14.
- Please leave backpacks and bags in the cloakroom free of charge. Suitcases larger than carry-on size may not be brought into the exhibition.

INFORMATION CENTRE

0 Start

The exhibition begins with an overview of the national socialist terror policies from 1933 to 1945. The persecution and murder of Jews in Europe is presented via rows of images and text. Six large-scale portraits represent the approximately 6 million victims.

1 Room of Dimensions

Diary entries, letters and final notes written during the period of persecution form the focus of the first exhibition room. The personal level is supplemented by the inclusion of details on the number of victims in the affected European border countries as of 1937.

2 Room of Families

15 families represent various Jewish home environments. Photos and personal documents reflect the diversity of European Judaism before the Holocaust and give an account of the expulsion and murder of these people.

3 Room of Names

Here you can hear the names and short biographies of murdered and missing Jews from across Europe. It would take approximately six years, seven months and 27 days to read the life stories of all the victims aloud in this form. Thanks to the Association for the Memorial to the Murdered Jews of Europe, the room is being constantly expanded.

4 Room of Sites

In this room, the Holocaust is represented in its geographical entirety across all of Europe. Focus is placed on the locations of crimes in central and eastern Europe. 220 examples of locations where European Jews and other victims were persecuted and exterminated are presented using historical film and image material.

5 6 Conclusion

The terminals give you access to memorial portals in places of remembrance throughout Europe, interviews with Holocaust survivors, and further databases.

2 · Room of Families

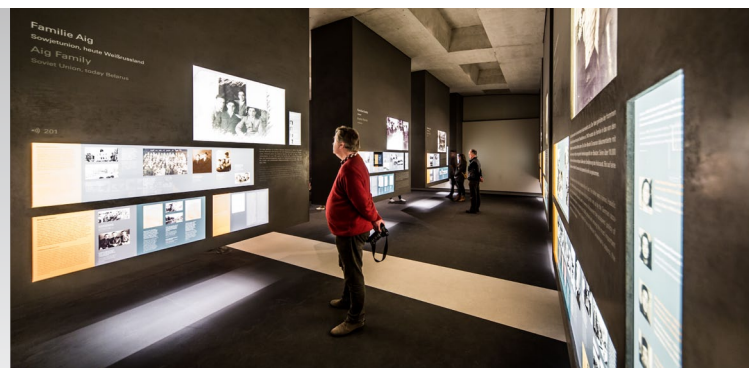

4 · Room of Sites

